



**EUROCONE**  
PLATED SCREW FITTINGS  
FOR MULTILAYER PIPE WITH ADAPTOR

**EUROCONO**  
*RACCORDI A STRINGERE GALVANICAMENTE TRATTATI  
PER TUBO MULTISTRATO CON KIT ADATTATORE*



EN

IT



#### TYPE OF PRODUCT

Brass screw fittings

#### FUNCTION

Fittings for sanitary water supply system  
Fittings for heating systems

#### SYSTEM

The compatibility of the fittings with multilayer pipes manufactured by others or of different type must be expressly approved by Comisa S.p.A. which, after executing its tests protocol, shall issue a guarantee certificate.

#### INSTRUCTIONS FOR USE

Please follow the instructions provided by Comisa S.p.A. strictly.

#### PERFORMANCE

Maximum operating pressure	10 bars
Maximum operating temperature	95° C
Maximum peak temperature	110° C (1 hr)

Data refers to the Comisa fittings combined with Comisa multilayer pipe

#### WARRANTY

10 years in compliance with the law. Such warranty shall not be deemed valid in case:

- Installation is not carried out according to the installation instructions indicated in the Comisa S.p.A. publications
- The circuit is used for conveying liquids different from those indicated in the Comisa S.p.A. publications
- Liquids are introduced into the circuit at pressure and temperature values different from the respective restrictions indicated in the Comisa S.p.A. publications

#### CERTIFICATES

The Comisa Press system is certified by DVGW (n. DW-8501BT0290)

For the installation of compression fittings, it is not necessary to avail of pressure tools and jaws; the seal is carried out simply by tightening a nut with a normal wrench.

This operation causes the deformation of a compression ring which compresses the multilayer pipe on the tail which is inserted into it.

The materials used for the components of the fittings and the O-rings are exactly the same as the Comisa Press fittings and the guarantee of duration is identical. In the Comisa Eurocone series the fitting can be separated from the tail and so the joint can be inspected.

In the Comisa eurocone series fitting and tail are a single component. Both series of fittings are used in the same way and have the same features: the choice is dictated only by the preference of the installer.



Following the introduction on the market of multilayer pipes or fittings of uncontrolled origin, in order to protect their customers, COMISA states as follows:

The COMISA screw system, DVGW Certificate No. DW-8501BT0290, includes:

#### • COMISA screw fittings • COMISA multilayer pipe

For the use of pipe or fittings of other producer and/or of other sources, Comisa does not guarantee the perfect functioning, if not after the customer's request, following which COMISA will implement its test procedure for inspection.

**After successful testing, Comisa will issue a certificate of guarantee.**

**WARNING:** The pipe calibration is important and must be made with chip removal calibrators. Do not use calibrators for PE-X as not adequate.

#### TIPOLOGIA PRODOTTO

Raccordi a stringere in ottone

#### FUNZIONE

Raccordi per impianti di adduzione acqua sanitaria  
Raccordi per impianti di riscaldamento

#### SISTEMA

La compatibilità dei raccordi con tubo multistrato di altro produttore o di diversa tipologia deve essere esplicitamente richiesta a Comisa S.p.A. che, dopo avere attuato un proprio protocollo di prove, rilascerà una certificazione di garanzia.

#### SPECIFICHE PER L'UTILIZZO

Seguire scrupolosamente le istruzioni fornite da Comisa S.p.A.

#### PRESTAZIONI

Pressione max di esercizio	10 bar
Temperatura max di esercizio	95°C
Temperatura max di picco	110°C (1 h)

I dati sono riferiti ai raccordi Comisa abbinati a tubo multistrato Comisa.

#### GARANZIA

10 anni a norma di legge. Tale garanzia decade qualora:

- l'installazione non avvenga secondo le istruzioni di montaggio riportate nelle pubblicazioni di Comisa S.p.A.
- Il sistema venga impiegato per condurre liquidi diversi da quelli riportati nelle pubblicazioni di Comisa S.p.A.
- Nel sistema vengano immessi liquidi a valori di pressione e temperatura diversi dai rispettivi limiti riportati nelle pubblicazioni di Comisa S.p.A.

#### CERTIFICAZIONI

Il sistema Comisa Press è certificato da DVGW (n. DW-8501BT0290)

Per l'installazione di raccordi a stringere non è necessario disporre di macchina pressatrice e di ganasce; la tenuta viene effettuata semplicemente stringendo un dado con una normalissima chiave. Questa operazione causa la deformazione di una ogiva che comprime il tubo multistrato sul portagomma che vi è inserito. I materiali utilizzati per i componenti dei raccordi e gli OR sono esattamente gli stessi dei raccordi Comisa e la garanzia di durata è identica.

Nella serie Comisa Eurocono il corpo raccordo è separabile dal portagomma e perciò la giunzione è ispezionabile.

Nella serie Unik corpo raccordo e portagomma sono realizzati in unico elemento.

Entrambe le serie di raccordi trovano la stessa applicazione ed hanno le medesime caratteristiche: la scelta è dettata solo dalla preferenza dell'installatore.



/ A seguito della immissione sul mercato di tubi multistrato o di raccorderie di incontrollata provenienza, al fine di tutelare la propria clientela, COMISA precisa quanto segue:

Il sistema a stringere COMISA, certificato DVGW n. 8501BT0290, è composto da:

#### • Raccordi a stringere COMISA • Tubo multistrato COMISA

Per l'utilizzo di tubo o di raccorderie di altro produttore e/o di altra provenienza, non si garantisce il perfetto funzionamento, se non previa richiesta del cliente, a seguito della quale Comisa attuerà il proprio protocollo di test per la verifica stessa.

**Ad esito positivo delle prove, COMISA rilascerà una autocertificazione di garanzia.**

**ATTENZIONE:** La calibrazione del tubo è importantissima e deve essere fatta con calibratori ad asportazione di truciolo. Non utilizzare calibratori per tubo PE-X in quanto non adeguati.

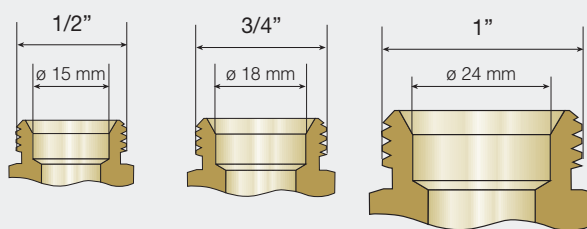

**EUROCONE SIZES / MISURE EUROCONO**

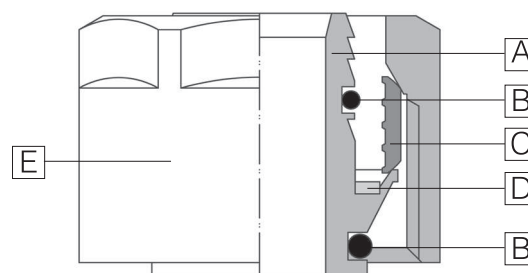
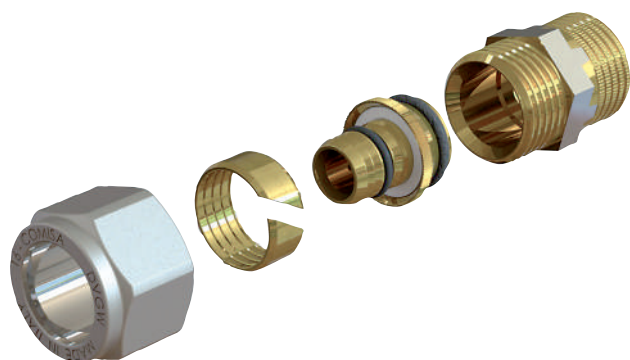

**MATERIALS**  
/ MATERIALI

- A) **Insert:** EN 12165 CW 617 N brass suitable for the passage of nutritional liquids intended for human consumption
- B) **O-Ring:** made with EPDM-peroxide blend
- C) **Olive:** EN 12165 CW 617 N brass suitable for the passage of nutritional liquids intended for human consumption
- D) **Spacer:** Insulating plastic material
- E) **Nut:** EN 12165 CW 617 N brass suitable for the passage of nutritional liquids intended for human consumption

- A) **Inserto:** ottone EN 12165 CW 617 N adatto per il passaggio di liquidi alimentari destinati al consumo umano
- B) **O-Ring:** realizzati con mescola EPDM-perossidico
- C) **Ogiva:** ottone EN 12165 CW 617 N adatto per il passaggio di liquidi alimentari destinati al consumo umano
- D) **Distanziale:** materiale plastico isolante
- E) **Dado:** ottone EN 12165 CW 617 N adatto per il passaggio di liquidi alimentari destinati al consumo umano

**TABLE FOR CALCULATING LOCALISED FRICTION LOSSES (EXPRESSED IN EQUIVALENT PIPE METRES) EQUIVALENT LENGTHS**  
/ TABELLA PER IL CALCOLO DELLE PERDITE DI CARICO LOCALIZZATE (ESPRESSE IN METRI EQUIVALENTI DI TUBO) LUNGHEZZE EQUIVALENTI

<b>Ø 16 x 2,0</b>	0,80	0,70	0,60	1,40	1,80	0,35	0,80
<b>Ø 18 x 2,0</b>	1,00	0,90	0,80	1,60	2,10	0,45	1,00
<b>Ø 20 x 2,5</b>	1,10	1,00	0,90	1,70	2,20	0,45	1,10
<b>Ø 20 x 2,0</b>	1,30	1,15	1,00	1,90	2,70	0,50	1,30
<b>Ø 26 x 3,0</b>	1,80	1,60	1,40	2,50	4,30	0,65	1,80

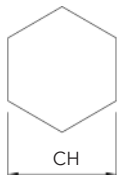
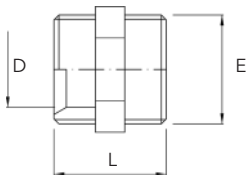

SIZE	E	D	L	CH	TECH. CODE
1/2" euro	1/2"	Ø 15	27	21	RM057000500N
3/4" euro	3/4"	Ø 18	27	26	RM057000700N
1" euro	1"	Ø 24	28	33	RM057001000N

**570**  
STRAIGHT COUPLER  
/ RACCORDO DIRITTO

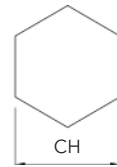
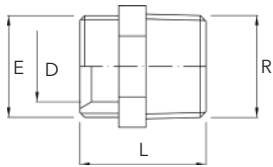

SIZE	E	D	L	CH	R	TECH. CODE
1/2" euro x 1/2"	1/2"	Ø 15	30	21	1/2"	RM057100505N
3/4" euro x 1/2"	3/4"	Ø 18	32	26	1/2"	RM057100507N
3/4" euro x 3/4"	3/4"	Ø 18	33	27	3/4"	RM057100707N
1" euro x 3/4"	1"	Ø 24	32	33	3/4"	RM057100710N
1" euro x 1"	1"	Ø 24	34	33	1"	RM057101010N

**571**  
MALE COUPLER  
/ RACCORDO DIRITTO MASCHIO

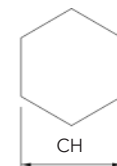
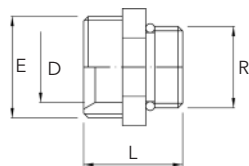

SIZE	E	D	L	CH	R	TECH. CODE
3/4" euro x 1/2"	3/4"	Ø 18	26	26	1/2"	RM0572005070 yellow / giallo
3/4" euro x 1/2"	3/4"	Ø 18	26	26	1/2"	RM057200507N nickel plated / nichelato

**572**  
MALE STRAIGHT COUPLER  
WITH O-RING SEAL  
/ RACCORDO DIRITTO MASCHIO  
CON O-RING

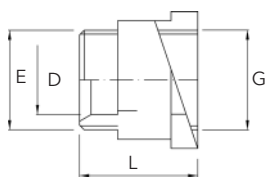

SIZE	E	D	L	CH	G	TECH. CODE
1/2" euro x 1/2"	1/2"	Ø 15	29	25	1/2"	RM058000505N
3/4" euro x 1/2"	3/4"	Ø 18	27	25	1/2"	RM058000507N
3/4" euro x 3/4"	3/4"	Ø 18	29	31	3/4"	RM058000707N
1" euro x 3/4"	1"	Ø 24	28	31	3/4"	RM058000710N
1" euro x 1"	1"	Ø 24	30	38	1"	RM058001010N

**580**  
FEMALE COUPLER  
/ RACCORDO DIRITTO FEMMINA

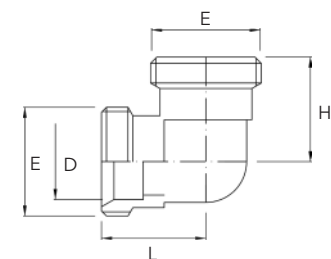

SIZE	E	D	L	H	TECH. CODE
1/2" euro	1/2"	Ø 15	22	22	RM056000500N
3/4" euro	3/4"	Ø 18	25	25	RM056000700N
1" euro	1"	Ø 24	30	30	RM056001000N

**560**  
ELBOW 90°  
/ GOMITO 90°

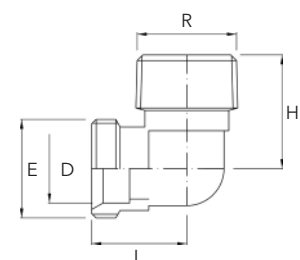

SIZE	E	D	L	R	H	TECH. CODE
1/2" euro x 1/2"	1/2"	Ø 15	24	1/2"	26	RM056100505N
3/4" euro x 1/2"	3/4"	Ø 18	26	1/2"	26	RM056100507N
3/4" euro x 3/4"	3/4"	Ø 18	25	3/4"	30	RM056100707N
1" euro x 1"	1"	Ø 24	30	1"	37	RM056101010N
1" euro x 3/4"	1"	Ø 24	30	3/4"	34	RM056100710N

**561**  
MALE ELBOW 90°  
/ GOMITO 90°



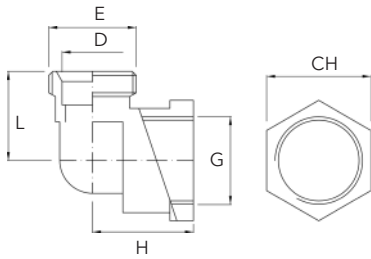

SIZE	E	D	L	CH	G	H	TECH. CODE
1/2" euro x 1/2"	1/2"	Ø 15	24	25	1/2"	25	RM056200505N
3/4" euro x 1/2"	3/4"	Ø 18	27	25	1/2"	27	RM056200507N
3/4" euro x 3/4"	3/4"	Ø 18	28	31	3/4"	27	RM056200707N
1" euro x 3/4"	1"	Ø 24	30		3/4"	32	RM056200710N
1" euro x 1"	1"	Ø 24	30		1"	38	RM056201010N

### 562

FEMALE ELBOW 90°  
/ GOMITO 90° FEMMINA

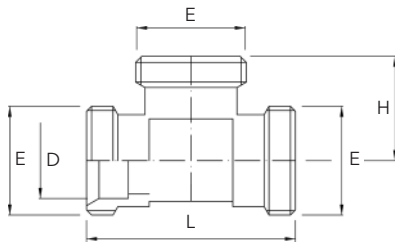

SIZE	E	D	L	H	TECH. CODE
1/2" euro	1/2"	Ø 15	44	22	RM055000500N
3/4" euro	3/4"	Ø 18	50	25	RM055000700N
1" euro	1"	Ø 24	60	30	RM055001000N

### 550

TEE  
/ RACCORDO A T

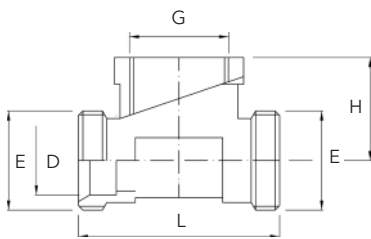

SIZE	E	D	L	G	H	TECH. CODE
1/2" euro x 1/2" x 1/2" euro	1/2"	Ø 15	47	1/2"	22	RM055200505N
3/4" euro x 1/2" x 3/4" euro	3/4"	Ø 18	53	1/2"	27	RM055200507N
3/4" euro x 3/4" x 3/4" euro	3/4"	Ø 18	53	3/4"	27	RM055200707N
1" euro x 3/4" x 1" euro	1"	Ø 24	64	3/4"	27	RM055200710N
1" euro x 1" x 1" euro	1"	Ø 24	64	1"	32	RM055201010N

### 552

FEMALE TEE  
/ RACCORDO A T FEMMINA

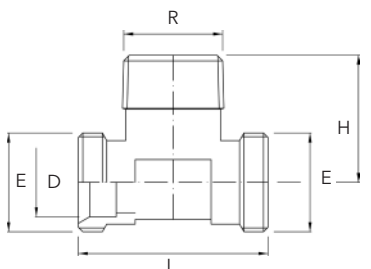

SIZE	E	D	L	R	H	TECH. CODE
1/2" euro x 1/2" x 1/2" euro	1/2"	Ø 15	44	1/2"	29	RM055100505N
3/4" euro x 3/4" x 3/4" euro	3/4"	Ø 18	50	3/4"	34	RM055100707N
1" euro x 3/4" x 1" euro	1"	Ø 24	65	3/4"	34	RM055101010N

### 551

MALE TEE  
/ RACCORDO A T MASCHIO



SIZE	E	D	L	CH	G	H	F	TECH. CODE
1/2" euro x 1/2"	1/2"	Ø 15	24	25	1/2"	39	34	RM056300505N
3/4" euro x 1/2"	3/4"	Ø 18	27	25	1/2"	44	32	RM056300507N
3/4" euro x 3/4"	3/4"	Ø 18	27	31	3/4"	50	32	RM056300707N

### 563

WALLPLATE ELBOW 90°  
/ GOMITO 90° FLANGIATO



**3** FIXING HOLES

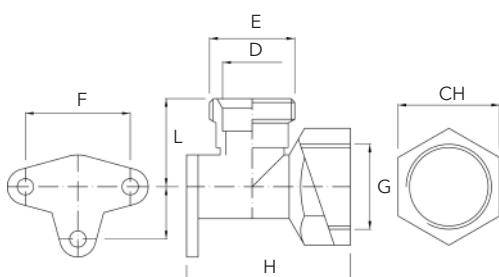



SIZE	CH	H	G	D	LI	E	TECH. CODE
16 x 2 - 1/2"	24	18	1/2"	Ø 16	14	1/2" - Ø 15	<b>DC055001612N</b>
16 x 2,25 - 1/2"	24	18	1/2"	Ø 16	14	1/2" - Ø 15	<b>DC055000556N</b>

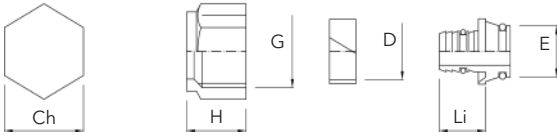

**1/2"**

**SCREW FITTING FOR MULTILAYER PIPE**

/ KIT A STRINGERE PER TUBO MULTISTRATO



SIZE	CH	H	G	D	LI	E	TECH. CODE
14 x 2 - 3/4"	27	18	3/4"	Ø 14	15	3/4" - Ø 18	<b>DC0221C1410N</b>
16 x 2 - 3/4"	27	18	3/4"	Ø 16	15	3/4" - Ø 18	<b>DC0221C1612N</b>
16 x 2,25 - 3/4"	27	18	3/4"	Ø 16	15	3/4" - Ø 18	<b>DC0221C0556N</b>
17 x 2 - 3/4"	27	21	3/4"	Ø 17	15	3/4" - Ø 18	<b>DC0221C1713N</b>
18 x 2 - 3/4"	27	21	3/4"	Ø 18	15	3/4" - Ø 18	<b>DC0221C1814N</b>
20 x 2 - 3/4"	27	21	3/4"	Ø 20	15	3/4" - Ø 18	<b>DC0221C2016N</b>
20 x 2,5 - 3/4"	27	21	3/4"	Ø 20	15	3/4" - Ø 18	<b>DC0221C2015N</b>

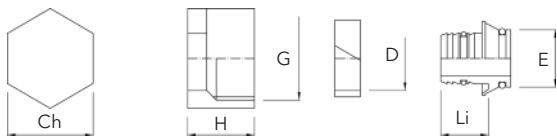

**3/4"**

**SCREW FITTING FOR MULTILAYER PIPE**

/ KIT A STRINGERE PER TUBO MULTISTRATO



SIZE	CH	H	G	D	LI	E	TECH. CODE
16 x 2 - 1"	37	17	1"	Ø 16	15	1" - Ø 24	<b>DC055201612N</b>
20 x 2 - 1"	37	17	1"	Ø 20	15	1" - Ø 24	<b>DC055202016N</b>
26 x 3 - 1"	37	19	1"	Ø 26	16	1" - Ø 24	<b>DC055202620N</b>

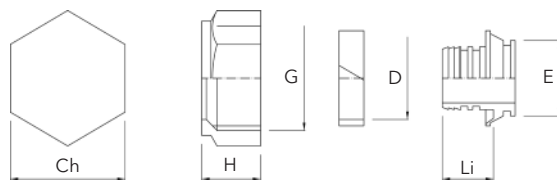

**1"**

**SCREW FITTING FOR MULTILAYER PIPE**

/ KIT A STRINGERE PER TUBO MULTISTRATO



SIZE	CH	H	G	D	LI	E	TECH. CODE
12 x 2 - 3/4" <b>PE-X</b>	27	18	3/4"	Ø 12	15	3/4" - Ø 18	<b>DC022101208N</b>
14 x 2 - 3/4" <b>PE-X</b>	27	18	3/4"	Ø 14	15	3/4" - Ø 18	<b>DC022101410N</b>
16 x 2 - 3/4" <b>PE-X</b>	27	18	3/4"	Ø 16	15	3/4" - Ø 18	<b>DC022101612N</b>
17 x 2 - 3/4" <b>PE-X</b>	27	21	3/4"	Ø 17	15	3/4" - Ø 18	<b>DC022101713N</b>
20 x 2 - 3/4" <b>PE-X</b>	27	21	3/4"	Ø 20	15	3/4" - Ø 18	<b>DC022102016N</b>

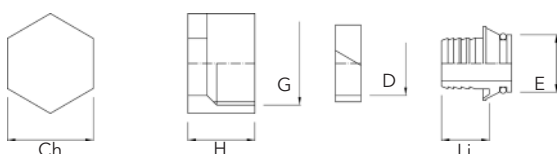

**PE-X PIPE!**

**3/4"**

**SCREW FITTING FOR PE-X PIPE**

/ KIT A STRINGERE PER TUBO PE-X







SIZE 	CH D	CH R	D	LI	H	TECH. CODE
16 x 2	24	21	Ø 16	14	57	RM057000016N
16 x 2,25	24	21	Ø 16	14	57	RM057000056N
14 x 2	27	26	Ø 14	15	57	RM057000014N
16 x 2	27	26	Ø 16	15	57	RM057000X16N
16 x 2,25	27	26	Ø 16	15	57	RM057000X56N
17 x 2	27	26	Ø 17	15	57	RM057000017N
18 x 2	27	26	Ø 18	15	57	RM057000018N
20 x 2	27	26	Ø 20	15	57	RM057000020N
20 x 2,5	27	26	Ø 20	15	57	RM057000051N
26 x 3	37	33	Ø 26	16	61	RM057000026N

### 570

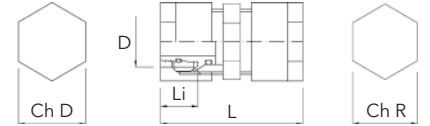
#### STRAIGHT COUPLER / RACCORDO DIRITTO



SIZE 	CH D	CH R	D	LI	L	R	TECH. CODE
16 x 2 - 1/2"	24	21	Ø 16	14	45	1/2"	RM057100516N
16 x 2,25 - 1/2"	24	21	Ø 16	14	45	1/2"	RM057100556N
14 x 2 - 1/2"	27	26	Ø 14	15	47	1/2"	RM057100514N
16 x 2 - 1/2"	27	26	Ø 16	15	47	1/2"	RM05710X516N
16 x 2,25 - 1/2"	27	26	Ø 16	15	47	1/2"	RM05710X556N
17 x 2 - 1/2"	27	26	Ø 17	15	47	1/2"	RM057100517N
18 x 2 - 1/2"	27	26	Ø 18	15	47	1/2"	RM057100518N
20 x 2 - 1/2"	27	26	Ø 20	15	47	1/2"	RM057100520N
20 x 2,5 - 1/2"	27	26	Ø 20	15	47	1/2"	RM057100551N
16 x 2 - 3/4"	27	27	Ø 16	15	47	3/4"	RM057100716N
16 x 2,25 - 3/4"	27	27	Ø 16	15	47	3/4"	RM05710X756N
17 x 2 - 3/4"	27	27	Ø 17	15	47	3/4"	RM057100717N
18 x 2 - 3/4"	27	27	Ø 18	15	47	3/4"	RM057100718N
20 x 2 - 3/4"	27	27	Ø 20	15	47	3/4"	RM057100720N
20 x 2,5 - 3/4"	27	27	Ø 20	15	47	3/4"	RM057100751N
26 x 3 - 3/4"	37	33	Ø 26	16	48	3/4"	RM057100726N
26 x 3 - 1"	37	33	Ø 26	16	51	1"	RM057101026N
32 x 3 - 1"	48	44	Ø 32	20	54	1"	RM057101032N

### 571

#### MALE COUPLER / RACCORDO DIRITTO MASCHIO

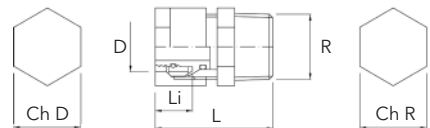

SIZE 	CH D	CH R	D1	D2	LI	L	TECH. CODE
18 x 2 - 16 x 2	27	26	Ø 18	Ø 16	15	57	RM0570R1816N
20 x 2 - 16 x 2	27	26	Ø 20	Ø 16	15	57	RM0570R2016N
20 x 2 - 17 x 2	27	26	Ø 20	Ø 17	15	57	RM0570R2017N
20 x 2 - 18 x 2	27	26	Ø 20	Ø 18	15	57	RM0570R2018N

### 570R

#### REDUCING COUPLER / RACCORDO DIRITTO RIDOTTO

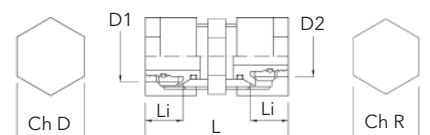



SIZE 	CH D	CH R	D	LI	L	R	TECH. CODE
16 x 2 - 1/2"	24	26	Ø 16	14	40	1/2"	RM057200516N
14 x 2 - 1/2"	27	26	Ø 14	15	40	1/2"	RM057200514N
16 x 2 - 1/2"	27	26	Ø 16	15	40	1/2"	RM05720X516N
17 x 2 - 1/2"	27	26	Ø 17	15	40	1/2"	RM057200517N
18 x 2 - 1/2"	27	26	Ø 18	15	40	1/2"	RM057200518N
20 x 2 - 1/2"	27	26	Ø 20	15	40	1/2"	RM057200520N

**572**

**MALE STRAIGHT COUPLER WITH O-RING SEAL**

/ RACCORDO DIRITTO MASCHIO CON O-RING

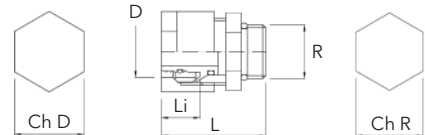

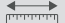

SIZE 	CH D	CH R	D	LI	L	R	TECH. CODE
16 x 2 - 1/2"	24	25	Ø 16	14	44	1/2"	RM058000516N
16 x 2,25 - 1/2"	24	25	Ø 16	14	44	1/2"	RM058000556N
14 x 2 - 1/2"	27	25	Ø 14	15	46	1/2"	RM058000514N
16 x 2 - 1/2"	27	25	Ø 16	15	46	1/2"	RM05800X516N
16 x 2,25 - 1/2"	27	25	Ø 16	15	46	1/2"	RM05800X556N
17 x 2 - 1/2"	27	25	Ø 17	15	46	1/2"	RM058000517N
18 x 2 - 1/2"	27	25	Ø 18	15	46	1/2"	RM058000518N
20 x 2 - 1/2"	27	25	Ø 20	15	46	1/2"	RM058000520N
20 x 2,5 - 1/2"	27	25	Ø 20	15	46	1/2"	RM058000551N
16 x 2 - 3/4"	27	31	Ø 16	15	46	3/4"	RM058000716N
16 x 2,25 - 3/4"	27	31	Ø 16	15	46	3/4"	RM05800X756N
17 x 2 - 3/4"	27	31	Ø 17	15	46	3/4"	RM058000717N
18 x 2 - 3/4"	27	31	Ø 18	15	46	3/4"	RM058000718N
20 x 2 - 3/4"	27	31	Ø 20	15	46	3/4"	RM058000720N
20 x 2,5 - 3/4"	27	31	Ø 20	15	46	3/4"	RM058000751N
26 x 3 - 3/4"	38	31	Ø 26	16	53	3/4"	RM058000726N
26 x 3 - 1"	38	38	Ø 26	16	53	1"	RM058001026N
32 x 3 - 1"	48	44	Ø 32	20	54	1"	RM058001032N

**580**

**FEMALE COUPLER**

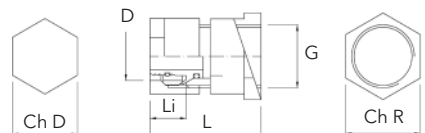
/ RACCORDO DIRITTO FEMMINA



SIZE 	CH D	CH R	D	LIS	H	TECH. CODE
16 x 2	24	Ø 16	14	37	37	RM056000016N
14 x 2	27	Ø 14	15	40	40	RM056000014N
16 x 2	27	Ø 16	15	40	40	RM056000X16N
17 x 2	27	Ø 17	15	40	40	RM056000017N
18 x 2	27	Ø 18	15	40	40	RM056000018N
20 x 2	27	Ø 20	15	40	40	RM056000020N
20 x 2,5	27	Ø 20	15	40	40	RM056000051N
26 x 3	37	Ø 26	16	46	46	RM056000026N
32 x 3	48	Ø 32	20	54	54	RM056000032N

**560**

**ELBOW 90°**

/ GOMITO 90°

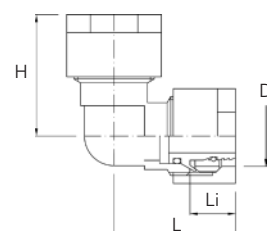





SIZE 	CH D	D	LI	L	H	R	TECH. CODE
16 x 2 - 1/2"	24	Ø 16	14	39	26	1/2"	RM056100516N
16 x 2,25 - 1/2"	24	Ø 16	14	39	26	1/2"	RM056100556N
14 x 2 - 1/2"	27	Ø 14	15	41	26	1/2"	RM056100514N
16 x 2 - 1/2"	27	Ø 16	15	41	26	1/2"	RM05610X516N
16 x 2,25 - 1/2"	27	Ø 16	15	41	26	1/2"	RM05610X556N
17 x 2 - 1/2"	27	Ø 17	15	41	26	1/2"	RM056100517N
18 x 2 - 1/2"	27	Ø 18	15	41	26	1/2"	RM056100518N
20 x 2 - 1/2"	27	Ø 20	15	41	26	1/2"	RM056100520N
20 x 2,5 - 1/2"	27	Ø 20	15	41	26	1/2"	RM056100551N
16 x 2 - 3/4"	27	Ø 16	15	40	30	3/4"	RM056100716N
17 x 2 - 3/4"	27	Ø 17	15	40	30	3/4"	RM056100717N
18 x 2 - 3/4"	27	Ø 18	15	40	30	3/4"	RM056100718N
20 x 2 - 3/4"	27	Ø 20	15	40	30	3/4"	RM056100720N
20 x 2,5 - 3/4"	27	Ø 20	15	40	30	3/4"	RM056100751N
26 x 3 - 3/4"	37	Ø 26	16	46	37	3/4"	RM056100726N
26 x 3 - 1"	37	Ø 26	16	46	34	1"	RM056101026N
32 x 3 - 1"	48	Ø 32	20	54	45	1"	RM056101032N

### 561

MALE ELBOW 90°  
/ GOMITO 90° MASCHIO

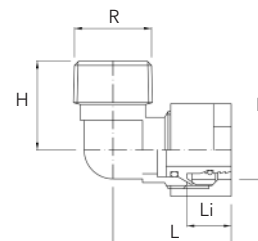

SIZE 	CH D	CH R	D	LI	L	H	G	TECH. CODE
16 x 2 - 1/2"	24	25	Ø 16	14	39	25	1/2"	RM056200516N
16 x 2,25 - 1/2"	24	25	Ø 16	14	39	25	1/2"	RM056200556N
14 x 2 - 1/2"	27	25	Ø 14	15	42	27	1/2"	RM056100514N
16 x 2 - 1/2"	27	25	Ø 16	15	42	27	1/2"	RM05620X516N
16 x 2,25 - 1/2"	27	25	Ø 16	15	42	27	1/2"	RM05620X556N
17 x 2 - 1/2"	27	25	Ø 17	15	42	27	1/2"	RM056200517N
18 x 2 - 1/2"	27	25	Ø 18	15	42	27	1/2"	RM056200518N
20 x 2 - 1/2"	27	25	Ø 20	15	42	27	1/2"	RM056200520N
20 x 2,5 - 1/2"	27	25	Ø 20	15	42	27	1/2"	RM056200551N
16 x 2 - 3/4"	27	31	Ø 16	15	42	27	3/4"	RM056200716N
18 x 2 - 3/4"	27	31	Ø 18	15	42	27	3/4"	RM056200718N
20 x 2 - 3/4"	27	31	Ø 20	15	42	27	3/4"	RM056200720N
20 x 2,5 - 3/4"	27	31	Ø 20	15	42	27	3/4"	RM056200751N
26 x 3 - 3/4"	37	\	Ø 26	16	46	32	3/4"	RM056200726N
26 x 3 - 1"	37	\	Ø 26	16	46	38	1"	RM056201026N
32 x 3 - 1"	48	\	Ø 32	20	54	45	1"	RM056201032N

### 562

FEMALE ELBOW 90°  
/ GOMITO 90° FEMMINA

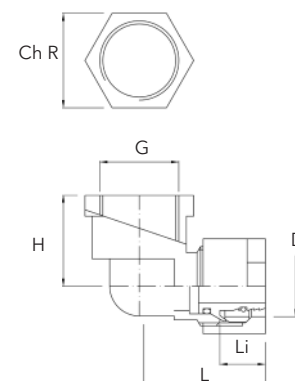



SIZE 	CH D	CH R	D	LI	L	R	TECH. CODE
16 x 2 - 1/2"	24	25	Ø 16	14	39	1/2"	RM056300516N
16 x 2,25 - 1/2"	24	25	Ø 16	14	39	1/2"	RM056300556N
14 x 2 - 1/2"	27	25	Ø 14	15	44	1/2"	RM056300514N
16 x 2 - 1/2"	27	25	Ø 16	15	44	1/2"	RM05630X516N
16 x 2,25 - 1/2"	27	25	Ø 16	15	44	1/2"	RM05630X556N
17 x 2 - 1/2"	27	25	Ø 17	15	44	1/2"	RM056300517N
18 x 2 - 1/2"	27	25	Ø 18	15	44	1/2"	RM056300518N
20 x 2 - 1/2"	27	25	Ø 20	15	44	1/2"	RM056300520N
20 x 2,5 - 1/2"	27	25	Ø 20	15	44	1/2"	RM056300551N
16 x 2 - 3/4"	27	31	Ø 16	15	49	3/4"	RM056300716N
17 x 2 - 3/4"	27	31	Ø 17	15	49	3/4"	RM056300717N
18 x 2 - 3/4"	27	31	Ø 18	15	49	3/4"	RM056300718N
20 x 2 - 3/4"	27	31	Ø 20	15	49	3/4"	RM056300720N

**563**

WALLPLATE ELBOW 90°  
/ GOMITO 90° FLANGIATO



3 FIXING HOLES

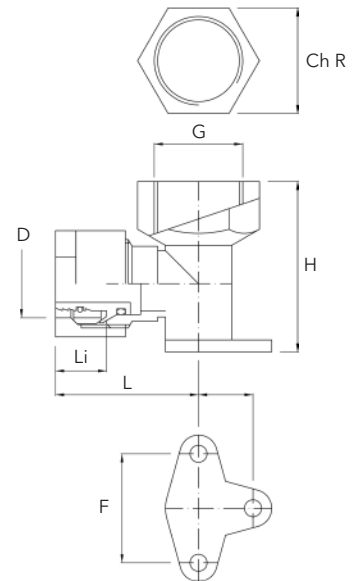

SIZE 	CH D	D	LI	L	H	TECH. CODE
16 x 2 - 16 x 2 - 16 x 2	24	Ø 16	14	74	37	RM055000016N
16 x 2,25 - 16 x 2,25 - 16 x 2,25	24	Ø 16	14	74	37	RM055000056N
14 x 2 - 14 x 2 - 14 x 2	27	Ø 14	15	80	40	RM055000014N
16 x 2 - 16 x 2 - 16 x 2	27	Ø 16	15	80	40	RM055000X16N
17 x 2 - 17 x 2 - 17 x 2	27	Ø 17	15	80	40	RM055000017N
18 x 2 - 18 x 2 - 18 x 2	27	Ø 18	15	80	40	RM055000018N
20 x 2 - 20 x 2 - 20 x 2	27	Ø 20	15	80	40	RM055000020N
20 x 2,5 - 20 x 2,5 - 20 x 2,25	27	Ø 20	15	80	40	RM055000051N
26 x 3 - 26 x 3 - 26 x 3	37	Ø 26	16	93	46	RM055000026N

**550**

TEE  
/ RACCORDO A T

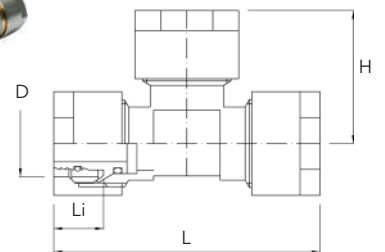

SIZE 	CH D	D1	LI1	D2	LI2	D3	LI3	L	H	TECH. CODE
16 x 2 - 20 x 2 - 16 x 2	27	Ø 16	15	Ø 20	15	Ø 16	15	80	40	RM055300ABAN
20 x 2 - 16 x 2 - 18 x 2	27	Ø 20	15	Ø 16	15	Ø 18	15	80	40	RM055300BACN
18 x 2 - 16 x 2 - 18 x 2	27	Ø 18	15	Ø 16	15	Ø 18	15	80	40	RM055300CACN
20 x 2 - 16 x 2 - 16 x 2	27	Ø 20	15	Ø 16	15	Ø 16	15	80	40	RM055300BAAN
20 x 2 - 16 x 2 - 20 x 2	27	Ø 20	15	Ø 16	15	Ø 20	15	80	40	RM055300BABN
20 x 2 - 18 x 2 - 20 x 2	27	Ø 20	15	Ø 18	15	Ø 20	15	80	40	RM055300BCBN
20 x 3 - 20 x 3 - 16 x 2	27	Ø 20	15	Ø 20	15	Ø 16	15	80	40	RM055300BBAN
26 x 3 - 16 x 3 - 26 x 3	27	Ø 26	15	Ø 16	15	Ø 26	16	93	46	RM055300DADN
26 x 3 - 20 x 3 - 26 x 3	37	Ø 26	16	Ø 20	15	Ø 26	16	93	46	RM055300DBDN

**553**

REDUCING TEE  
/ RACCORDO A T RIDOTTO

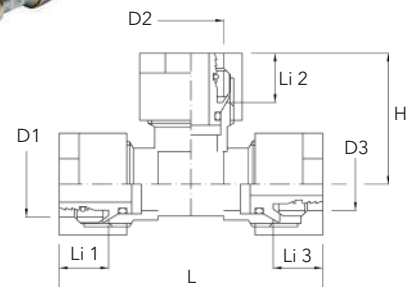



SIZE 	CH D	D	LI	L	H	G	TECH. CODE
16 x 2 - 1/2" - 16 x 2	24	Ø 16	14	78	22	1/2"	RM055200516N
16 x 2,25 - 1/2" 16 x 2,25	24	Ø 16	14	78	22	1/2"	RM055200556N
14 x 2 - 1/2" - 14 x 2	27	Ø 14	15	83	27	1/2"	RM055200514N
16 x 2 - 1/2" - 16 x 2	27	Ø 16	15	83	27	1/2"	RM05520X516N
16 x 2,25 - 1/2" 16 x 2,25	27	Ø 16	15	83	27	1/2"	RM05520X556N
17 x 2 - 1/2" x 17 x 2	27	Ø 17	15	83	27	1/2"	RM055200517N
18 x 2 - 1/2" - 18 x 2	27	Ø 18	15	83	27	1/2"	RM055200518N
20 x 2 - 1/2" - 20 x 2	27	Ø 20	15	83	27	1/2"	RM055200520N
20 x 2,5 - 1/2" 20 x 2,5	27	Ø 20	15	83	27	1/2"	RM055200551N
16 x 2 - 3/4" - 16 x 2	27	Ø 16	15	83	27	3/4"	RM055200716N
18 x 2 - 3/4" - 18 x 2	27	Ø 18	15	83	27	3/4"	RM055200718N
20 x 2 - 3/4" - 20 x 2	27	Ø 20	15	83	27	3/4"	RM055200720N
20 x 2,5 - 3/4" 20 x 2,5	27	Ø 20	15	83	27	3/4"	RM055200751N
26 x 3 - 3/4" - 26 x 3	37	Ø 26	16	97	32	3/4"	RM055200726N
26 x 3 - 1" - 26 x 3	37	Ø 26	16	97	32	1"	RM055201026N
32 x 3 - 1" - 32 x 3	48	Ø 32	20	108	45	1"	RM055201032N

### 552

#### FEMALE TEE

/ RACCORDO A T FEMMINA

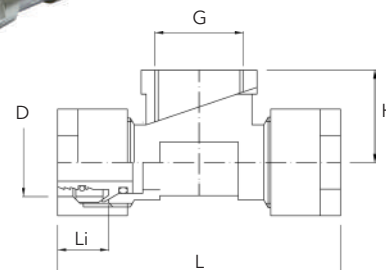

SIZE 	CH D	D	LI	L	H	G	TECH. CODE
16 x 2 - 1/2" - 16 x 2	24	Ø 16	14	78	22	1/2"	RM055100516N
16 x 2,25 - 1/2" 16 x 2,25	24	Ø 16	14	78	22	1/2"	RM055100714N
14 x 2 - 1/2" - 14 x 2	27	Ø 14	15	83	27	1/2"	RM055100716N
16 x 2 - 1/2" - 16 x 2	27	Ø 16	15	83	27	1/2"	RM055100718N
16 x 2,25 - 1/2" 16 x 2,25	27	Ø 16	15	83	27	1/2"	RM055100720N
17 x 2 - 1/2" x 17 x 2	27	Ø 17	15	83	27	1/2"	RM055100726N
18 x 2 - 1/2" - 18 x 2	27	Ø 18	15	83	27	1/2"	RM055101026N

### 551

#### MALE TEE

/ RACCORDO A T MASCHIO

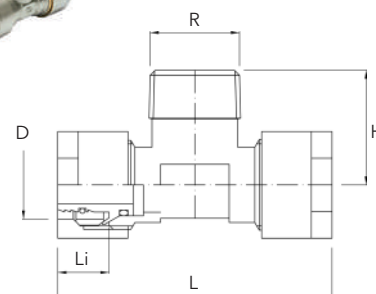

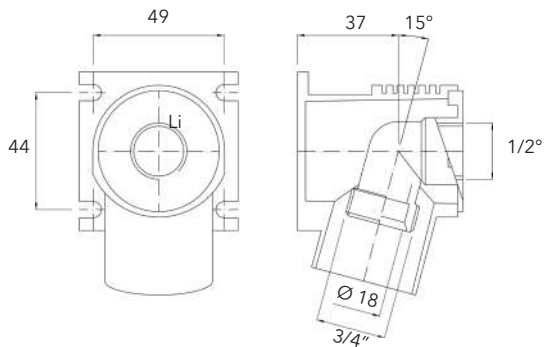

SIZE	TECH. CODE
3/4" euro x 1/2" F	RM0566007050

**566**

**BUILT-IN DISTRIBUTION BOX WITH 105° ELBOW**

/ SCATOLA DI DISTRIBUZIONE SOTTOTRACCIA CON GOMITO 105°

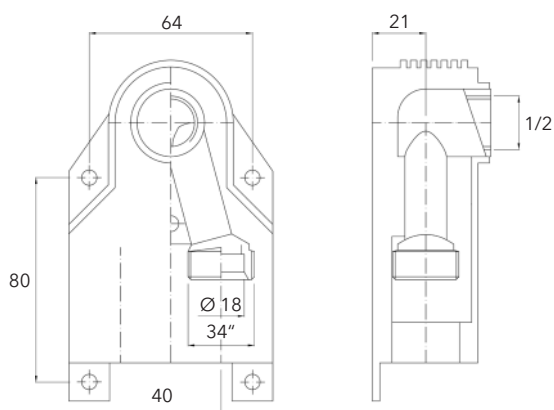

SIZE	TECH. CODE
3/4" euro x 1/2" F	RM0566007050

**568**

**DOUBLE-EXIT UNDERCARPET DISTRIBUTION BOX FOR SERIAL CONNECTIONS**

/ SCATOLA DI DISTRIBUZIONE SOTTOTRACCIA A 2 USCITE



SIZE	TECH. CODE
155mm	RM0565STAF01

**565**

**PLATE FOR UNDERCARPET DISTRIBUTION BOX**

/ DIMA PER SCATOLA DI DISTRIBUZIONE SOTTOTRACCIA

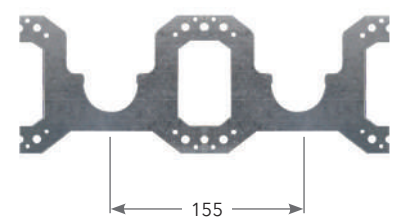









COMISA S.p.A. | Via Neziole, 27 | 25055 | PISOGNE (BS) Italy

**COMISA**



[WWW.COMISA.IT](http://WWW.COMISA.IT)